

SPECS + PRE-INSTALLATION REQUIREMENTS FOR THE VICTORIA ARDUINO EAGLE ONE E1 PRIMA

2024-JUNE

ELECTRICAL REQUIREMENTS

- **110 VOLT/15 AMP** (actual 1400W/13A)
- Standard **NEMA 5-15 receptacle** ①
- Receptacle should be installed within 3 ft (90cm) of machine + grinder(s), but can be above or below the counter.

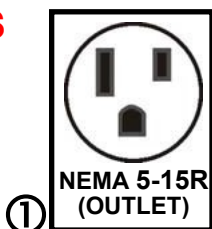

WATER REQUIREMENTS

- **WATER SOFTENING IS RECOMMENDED** for installed machines, to maintain a "hardness" level of **3-4 GPG (50-75 PPM)***.

- Your plumber should install a **1/2" dedicated COLD water line** with **shut-off valve** and a **3/8" compression fitting** ② within 3 feet (90cm) of the machine, and a **pressure reducer to a maximum of 3-4 bars (available @ Zuccarini)**.

- **SHUT-OFF ② MUST ALWAYS BE EASILY ACCESSIBLE IN CASE OF AN EMERGENCY!**

- If you choose our **BWT in-line water softening system**, the shut-off valve is normally installed **below your counter** ③ leaving space for (and access to) the filter assembly.

- *If using an in-home **REVERSE OSMOSIS (RO)** or similar system, **YOU MUST MAINTAIN 3 to 4 BARS OF PRESSURE** to the machine. Also, you may choose to install the water-line above OR below the counter. NB The machine comes with a 3 ft (90cm) flexible hose fitted with a **3/8" European fitting**, but we can provide a longer hose AND/OR a fitting to match it to your **North American 3/8" compression fitting** (extra charges may apply).

- **SPECS:** Water flow rate: 1GPM / TDS: 50-250ppm / Alkalinity: 10-150ppm / Chlorine: <0.50ppm / PH: 6.5-8.5 / Filtration: <1.0 micron

DRAINAGE (if you prefer not having to remove the drip tray when it fills up)

- A minimum 1" (2.5cm) diameter **under-counter open drain** within 3 ft (90cm) of the machine ④.
- **NOTE:** Drain hose (included) must always run **DOWNWARDS** (never bending upwards).

COUNTER REQUIREMENTS (if you're installing a BWT and/or DRAINAGE)

- **Minimum 2.5" (7cm) hole** in the counter **under the machine** for cold water, (drain hose & power supply):
 - **The hole should be under the spot where the machine sits, centred about 2 inches from the back.**
 - **IF ZUCCARINI IS INSTALLING YOUR MACHINE** and your **COUNTER-TOP IS MADE OF STONE, METAL, or >2" THICK WOOD**, THE HOLE MUST BE DRILLED **BEFORE** OUR INSTALLER ARRIVES
- Leave **vertical OR horizontal space** under the counter near the cold water shut-off ② for the **BWT Water Softener ③** (approx. 20"x5"x5" / 51x13x13cm) which must remain accessible for annual replacement.
- Suggested **counter height** is 36" to 40" (1 metre); suggested **vertical space above counter** is min. 19".

COUNTER SPACE REQUIREMENTS

Width: 16" (41cm) Depth: 20" (51cm)
Height: 14.75" (38cm) Weight: 82lb (30 kg)

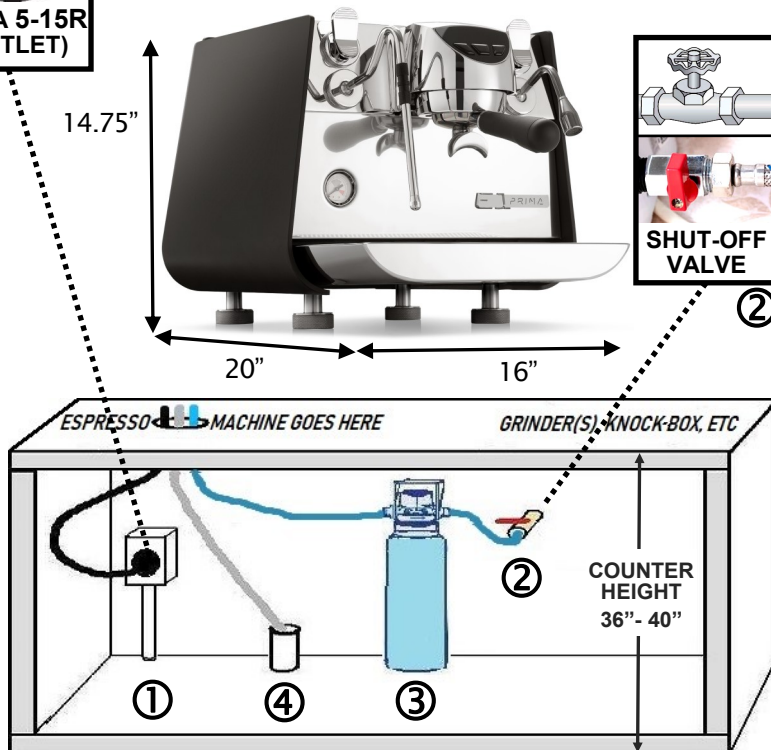

Victoria Arduino  **MADE IN ITALY**

**FAILURE TO HAVE SITE PREPARED AT TIME OF INSTALLATION APPOINTMENT
WILL CAUSE DELAYS & RESULT IN ADDITIONAL SERVICE & TRAVEL CHARGES.**



**ESPRESSO
MACHINES**

NO. 1335 DAVENPORT ROAD
TORONTO, ONTARIO M6H 2H4

416-537-3439

service@zuccarini.ca
ZUCCARINI.CA